



**MINI DRONE** K50

**INSTRUCTION MANUAL**

[www.xk-innovations.com](http://www.xk-innovations.com)

## PRODUCT FEATURES:

- Flight time: About 5 minutes (equipped with 3.7V 100 MAH Lithium Battery, it can reach the best effect after charged and discharging several times.);
2. 4G control distance: 20- 30 meters;
- performance: reliable frequency selection and strong anti-interference ability.

## PREPARATION:

1. After opening the package, remove the vehicle in the direction of the arrow. (Pic.1)
2. Open the inner cover to remove the controller. (Pic.2)
3. Use first nut daoba screws removed, According to the arrow direction take the controller battery cover. (Pic.3)
4. Install 2x 'AA' batteries with the correct polarity, then replace the battery cover. (Pic.4)



Pic.1



Pic.2

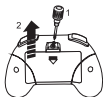

Pic.3

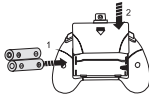

Pic.4

## **CHARGE:**

The USB charging cable end into the other end of the computer's USB port  
Inserted into the vehicle charging port, charging the red light extinguished,  
Charging is complete the red light, the charging time is approximately 30  
minutes .



Charge plug



Charger Interface

## **OPERATION:**

1. Press the controller button, the indicator light on the controller will light up follows you press the controller button. (Press any button on the controller, the controller function indicator light will light up).

2. The size of rudder switching and 3D roll: when pressing the action button to switch flight the size of the rudder, and the controller sends out the sound of small drops a louder sound of two rudder, Press the key to enter the 3D rolling state, the controller sends a drop sound, then play the right rocker towards any direction in the end can be achieved 3D roll.
3. headless mode: Flying vertically downward pressing right rocker into headless mode, enter the headless mode vehicle LED lamp flashes quickly. Note! The headless mode before use must take the aircraft nose before. And the operator can not change direction in flight.

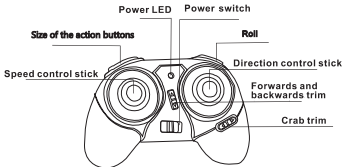

## **CAUTION:**

- a). If the Aircraft becomes apparently slower during operation, it might be due to insufficient power, please charge the car follow the illustration.
- b). Replace the new batteries of the controller if they lack of power, the car can't be charge the indicator lamp turns dim.
- c). Pay attention to the plug of charge & the charge position when charging.
- d). Please remove the battery of the controller and turn the power of car switch to "OFF" position when it is not used for a long time.
- e). Non rechargeable batteries are not to be recharged. Rechargeable batteries should only be charged under adult supervision.
- f). Old and new batteries of different types of batteries are not to be mixed.
- g). Batteries are to be inserted with the correct polarity, avoid install of mistake.
- h). Do not short circuit the batteries terminals.
- i). Remove the packing under adult supervision.
- j). Please retain the above information for future reference.



Shenzhen XK Innovations Technology Co., Ltd.

Email: [sales@xk-innovations.com](mailto:sales@xk-innovations.com)